

## DXD-20AS

## 工作条件 Working Conditions

介质温度:5-50°C

环境温度:≤50°C

湿度:65%RH

最大工作压力:0.4Mpa

Medium temperature:5-50°C

Environmental temperature:≤50°C

Humidity: 65% RH

Max.working pressure: 0.4Mpa

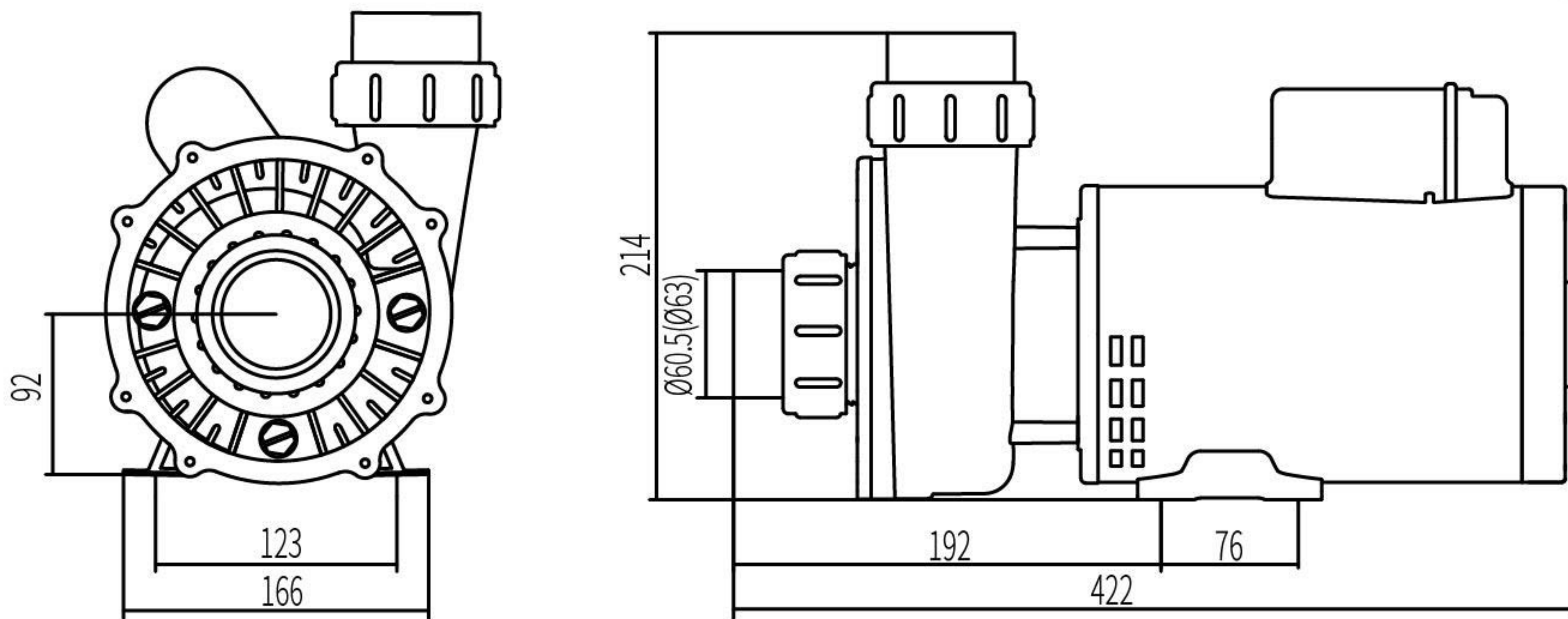

## 性能曲线 Performance Curves

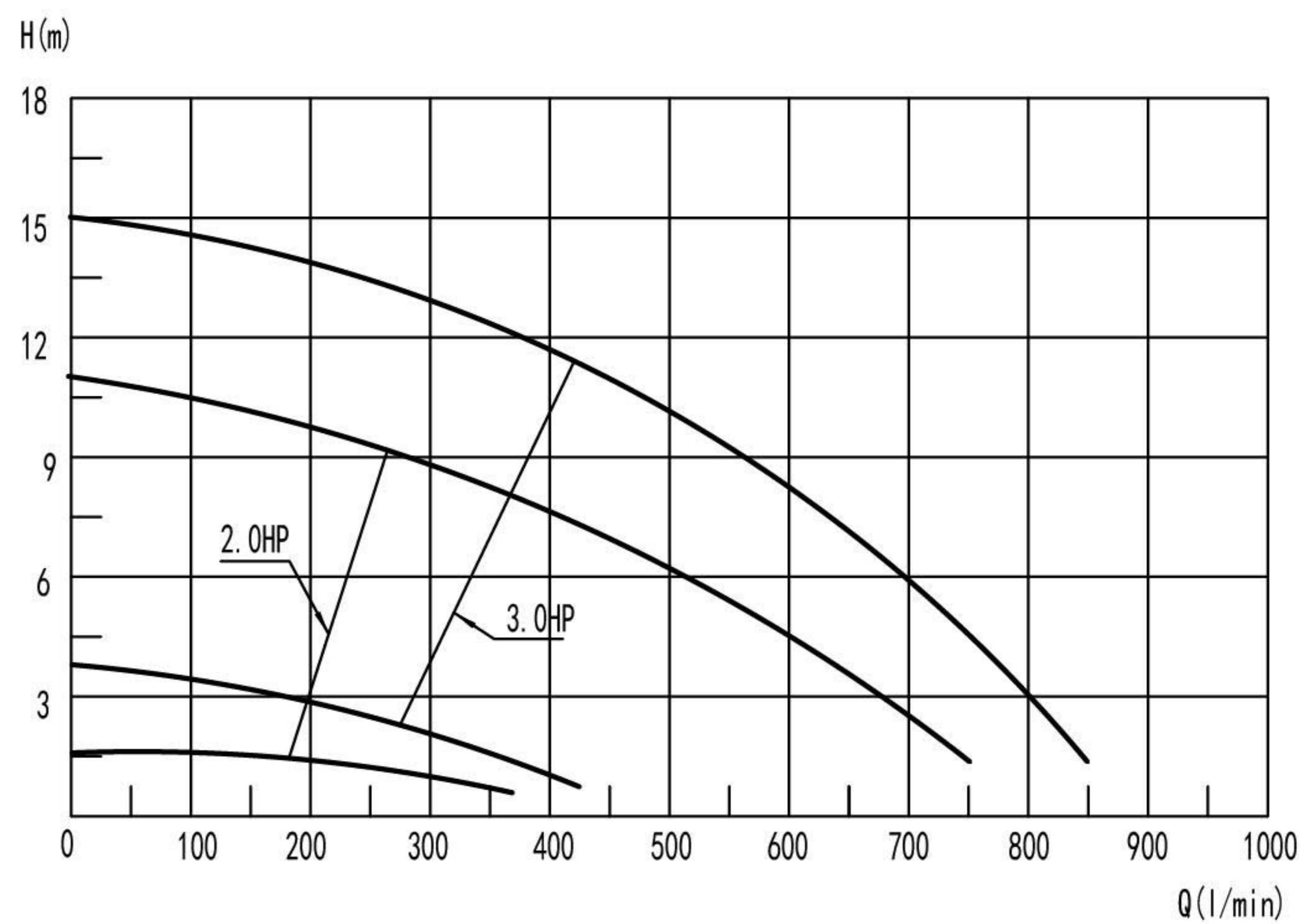

**UL** US E351970

## 技术参数 Technical Parameter List

型号 Model	电压 Voltage	功率 Power		转速 Rotating Speed (r/min)	最大扬程 Maximum Lift (m)	最大流量 Maximum Flow (l/min)	绝缘等级 Insulation Class	毛重 Gross Weight (kg)	认证 Certification
		Kw	HP						
DXD-20AS	230v/50Hz	(high speed) 1.5	2.0	2850	11.0	750	F	20.0	
		(low speed) 0.25	0.35	1450	1.5	366			
DXD-20CS	230v/60Hz	(high speed) 1.5	2.0	3450	11.0	750	F	20.0	
		(low speed) 0.25	0.35	1750	1.5	366			
DXD-20DS	115v/60Hz	(high speed) 1.5	2.0	3450	11.0	750	F	20.0	<b>UL</b> US
		(low speed) 0.25	0.35	1750	1.5	366			
DXD-30AS	230v/50Hz	(high speed) 2.2	3.0	2850	15.0	850	F	20.0	
		(low speed) 0.45	0.6	1450	3.5	416			
DXD-30CS	230v/60Hz	(high speed) 2.2	3.0	3450	15.5	850	F	20.0	
		(low speed) 0.45	0.6	1750	3.5	416			
DXD-30DS	115v/60Hz	(high speed) 2.2	3.0	3450	15.5	850	F	20.0	<b>UL</b> US
		(low speed) 0.45	0.6	1750	3.5	416			

包装 (Packing): 430mm×215mm×250mm