

DXD-1A

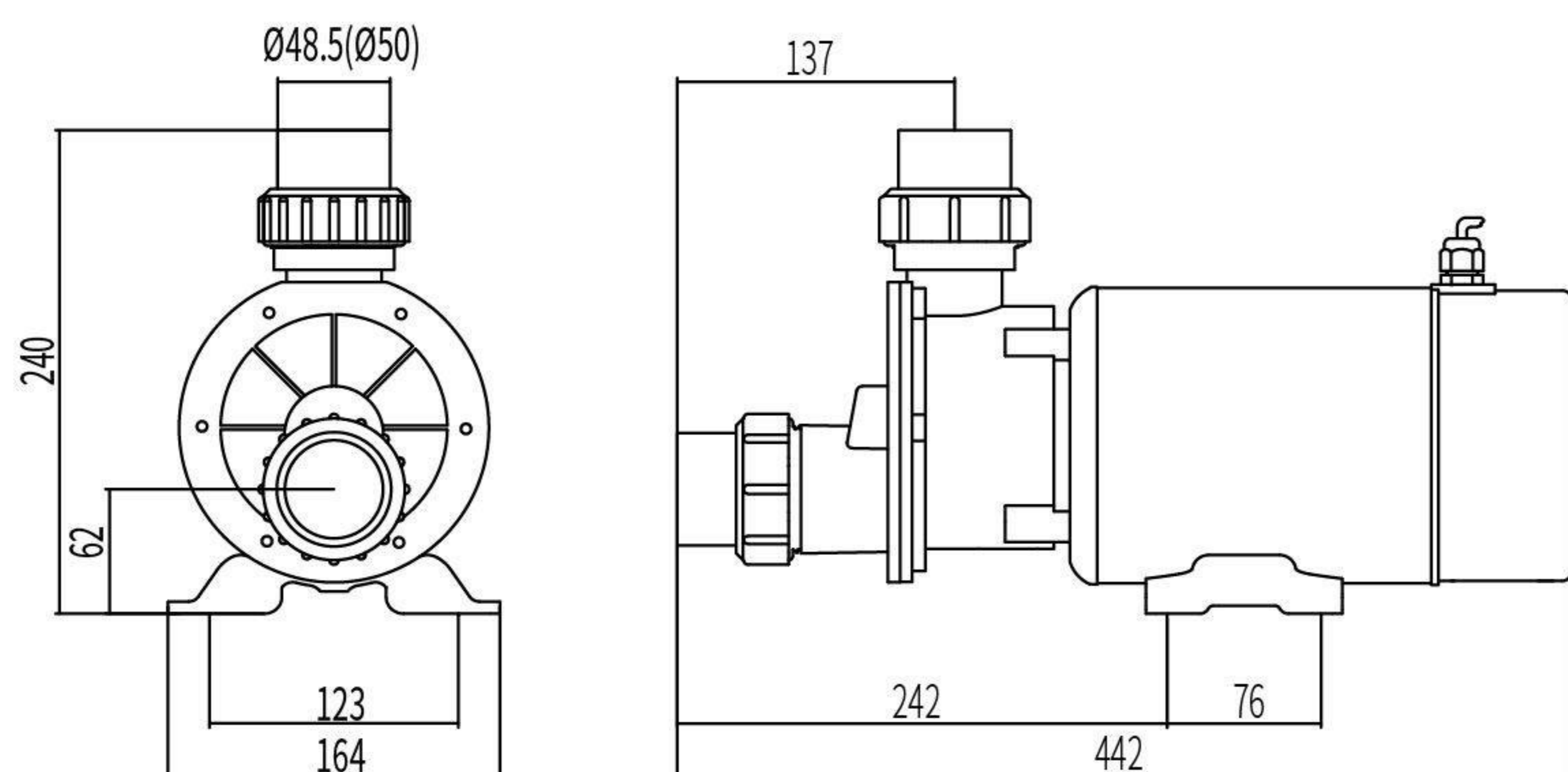



工作条件 Working Conditions

介质温度:5-50°C
 环境温度:≤50°C
 湿度:65%RH
 最大工作压力:0.4Mpa
 Medium temperature:5-50°C
 Environmental temperature:≤50°C
 Humidity: 65% RH
 Max.working pressure: 0.4Mpa

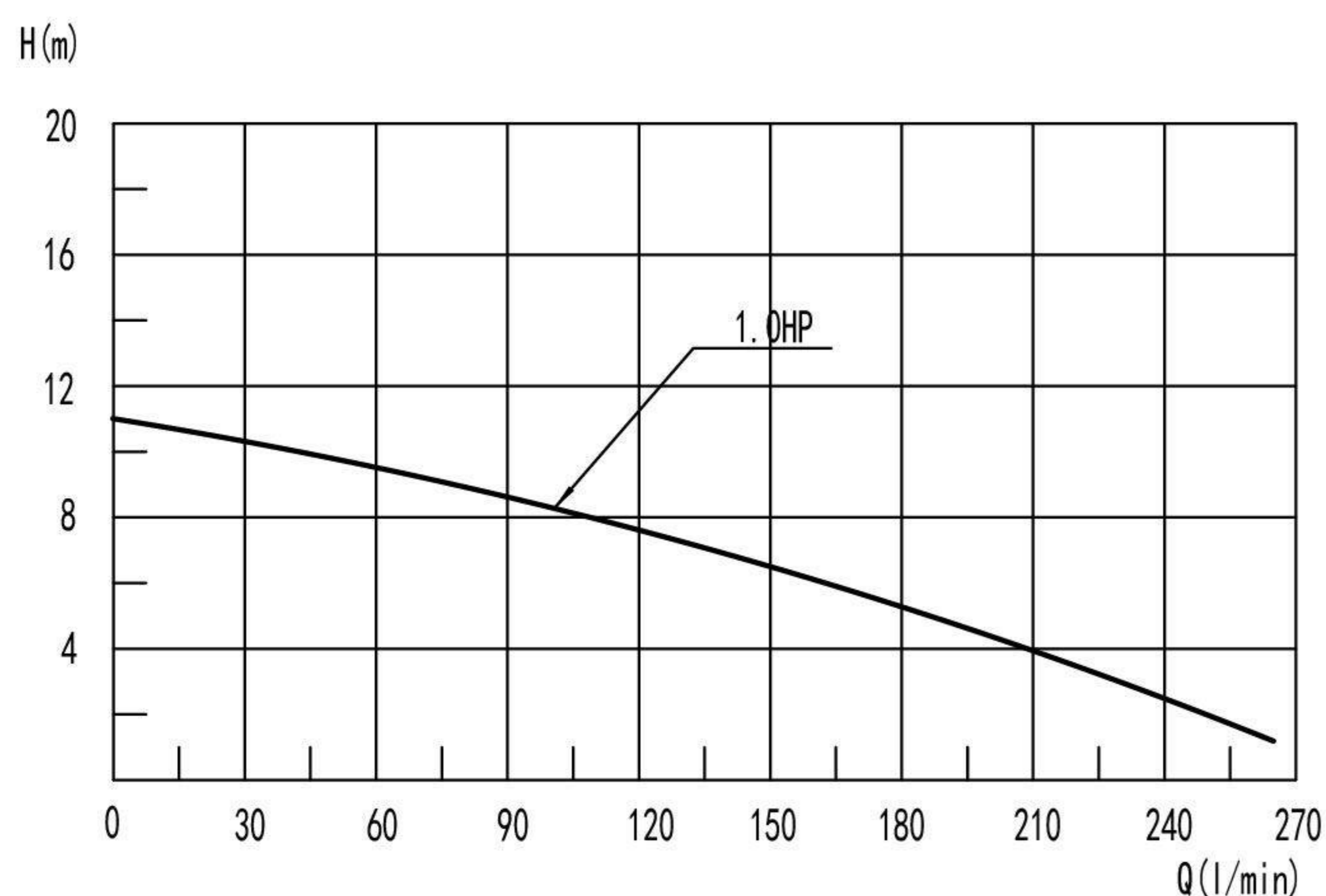



性能曲线 Performance Curves



-  K60335-1, K60335-2-41
  E351970
-  1538624
-  EN 60335-1:2012/A2:2019
 EN 60335-2-41:2003/A2:2010
 EN 62233:2008
-  EN 60335-1:2012/A2:2019
 EN 60335-2-41:2003/A2:2010
 EN 62233:2008

技术参数 Technical Parameter List

型号 Model	电压 Voltage	功率 Power		转速 Rotating Speed (r/min)	最大扬程 Maximum Lift (m)	最大流量 Maximum Flow (l/min)	绝缘等级 Insulation Class	毛重 Gross Weight (kg)	认证 Certification
		Kw	HP						
DXD-1A	230v/50Hz	0.75	1.0	2850	11.0	267	F	7.5	
DXD-1C	230v/60Hz	0.75	1.0	3450	11.0	267	F	7.5	
DXD-1-750	115v/60Hz	0.75	1.0	3450	11.0	267	F	7.5	

包装 (Packing): 440mm × 170mm × 210mm
 可选定时功能和无水保护装置 Optional function: Timer & No Water Protection